



**COLÉGIO ALMADA NEGREIROS,
CAMPOLIDE**

BUILDING HISTORY

The Colégio Almada Negreiros, known for many years as Colégio dos Jesuítas, was gradually built in the beginning of the second half of the 19th century, at the time administered by the Society of Jesus. Before being occupied by the NOVA University of Lisbon, it was also home to the “Batalhão de Caçadores 5”, which would leave the building in the 1970s.

HOW TO GET HERE

1,4 km
18 min.

1,8 km
8 min.
bicycle path

Carris
52B
Each 20 min.
17 min.
+ 5 min.

Carris
756
Each 15 min.
4 min.
+ 5 min.

TST
160
161
Each 30 min.
4 min.
+ 5 min.

SHUTTLE



Crowding or stocking
28 seats
Travel is not allowed standing

Ramp for reduced mobility



OUTPUT CAMPOLIDE

09h35
10h00
11h35
12h00
13h35
14h00
15h35
16h00
17h40



OUTPUT AV. BERNA

09h45
10h10
11h45
12h10
13h45
14h10
15h45
16h10
17h50

NOVA FCSH ensures a free shuttle service between the two spaces. Each trip is direct and takes approximately 10 minutes.

The starting point at Av. de Berna will be the CARRIS/TST stop in front of the main entrance. The stop at Colégio Almada Negreiros will be at the entrance via Rua da Mesquita.

Any member of the community can use this vehicle, marked as belonging to NOVA FCSH. To prove it, students must display their student card. Teachers, researchers or employees can use their business card or request a statement from the Faculty to access the shuttle.

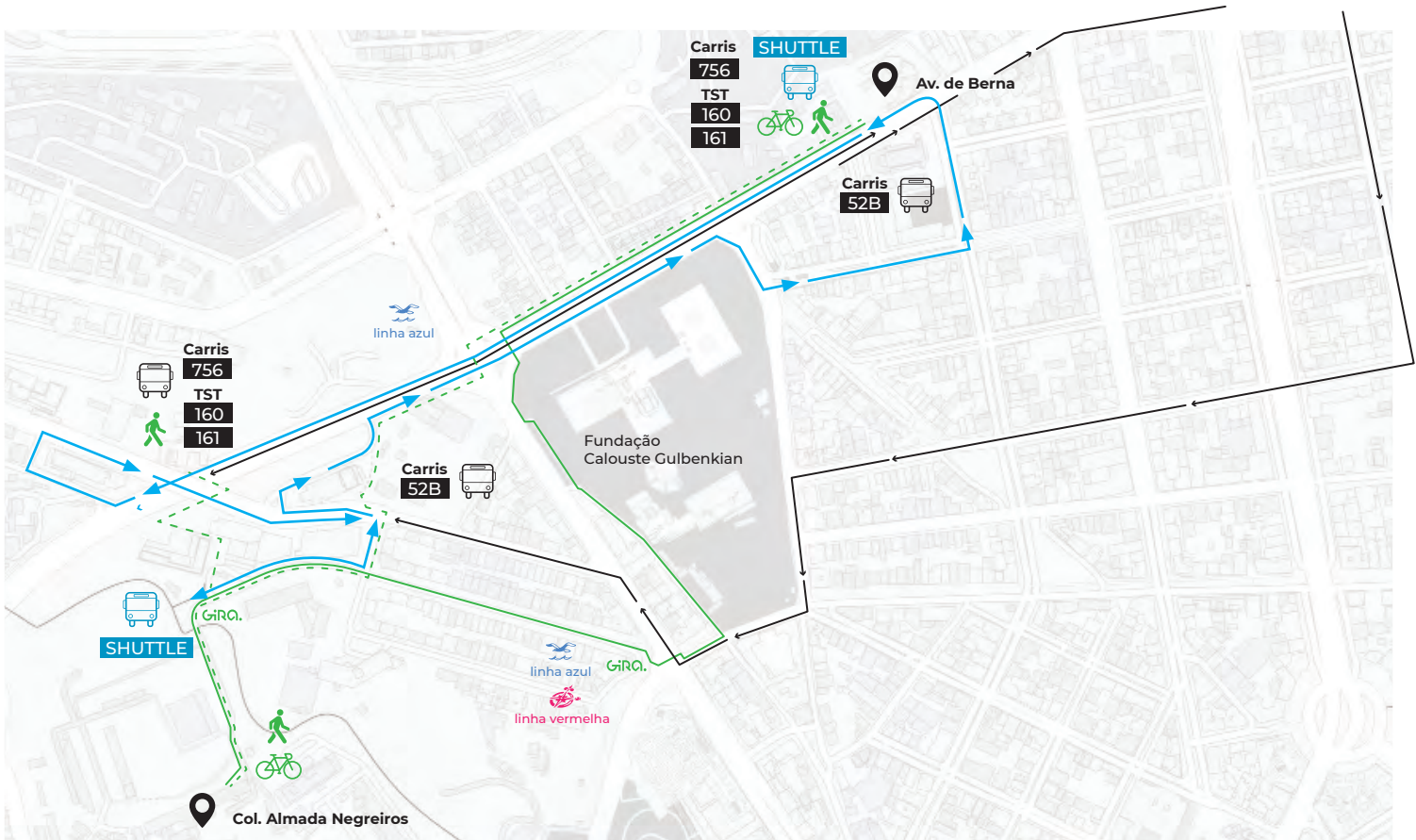

CAMPOLIDE Transport Network

Train CP



Sete Rios
Direct connection to the Subway blue line - Praça de Espanha station

Campolide
Carris lines:
756

Subway



linha azul
linha vermelha
São Sebastião station

linha azul
Praça de Espanha station

Carris



701
702
758

Carris Metropolitana



3703
3710



Bicycle park and a GIRA docking station

CAMPOLIDE

MAP

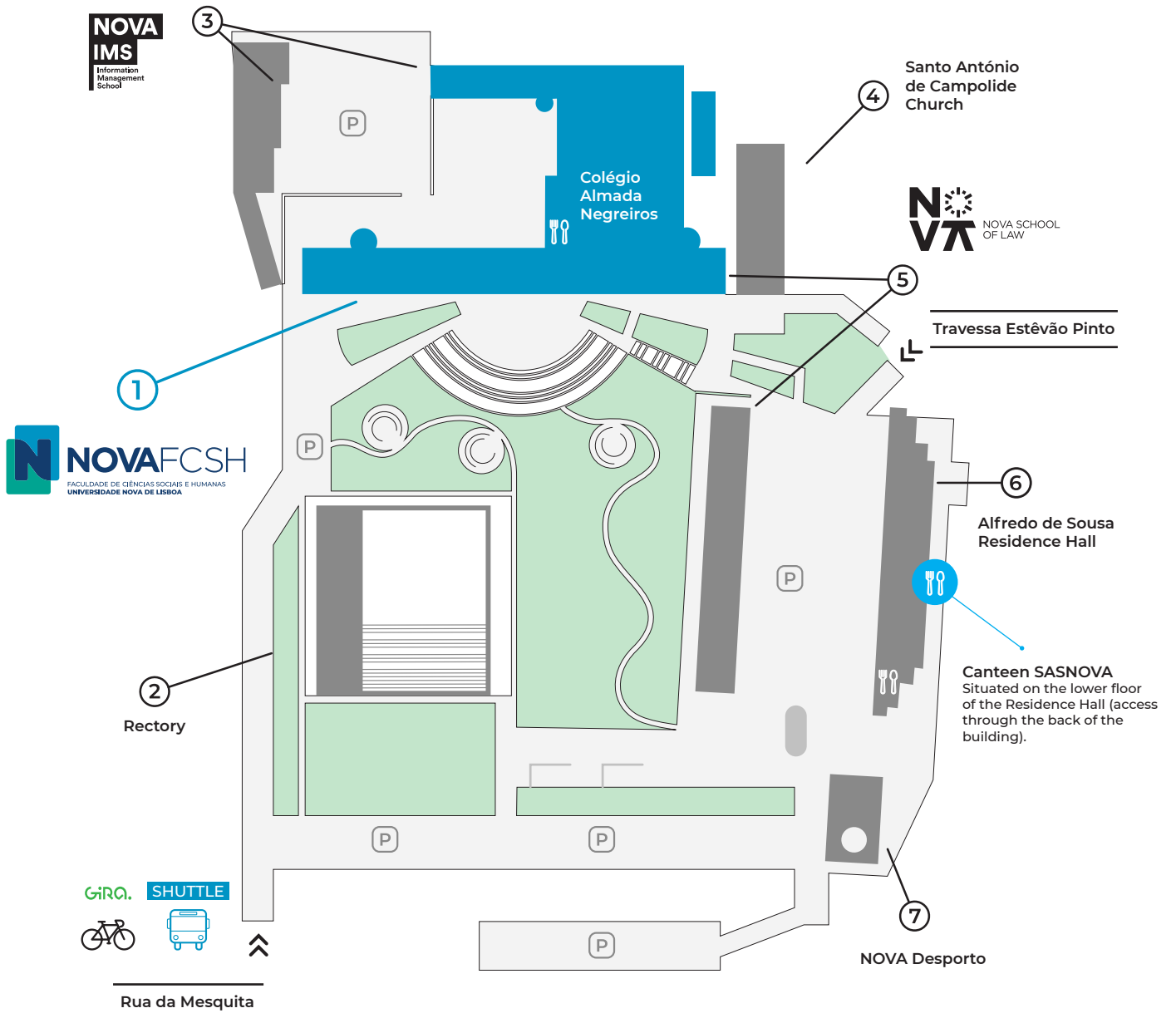

LEGEND



Bicycle park
GiRO.

SHUTTLE



Shuttle stop
NOVA FCSH



Dining space



Park



Canteen SAS NOVA

COLÉGIO ALMADA NEGREIROS

3RD FLOOR

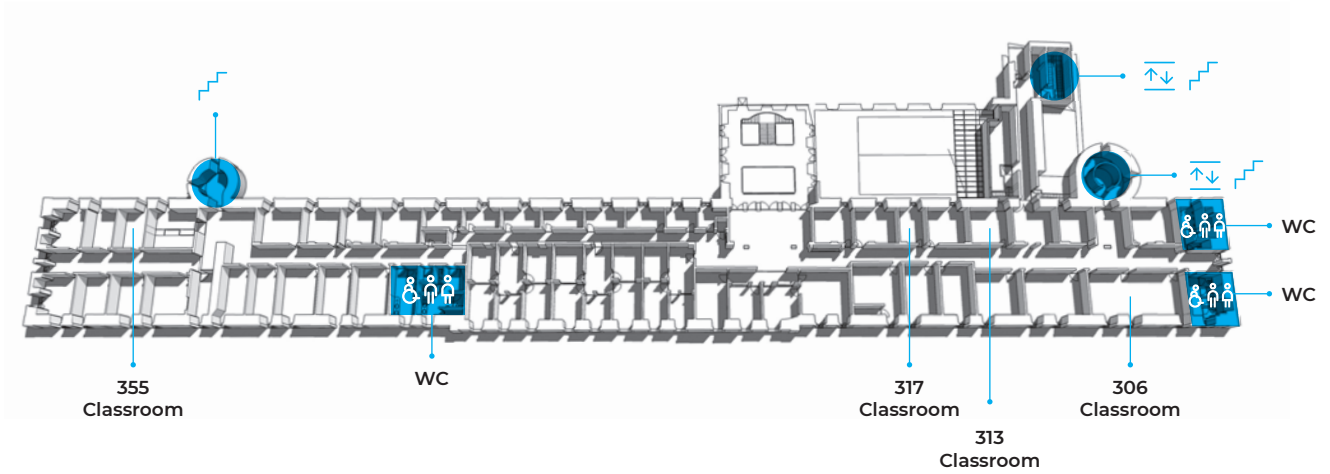

2ND FLOOR

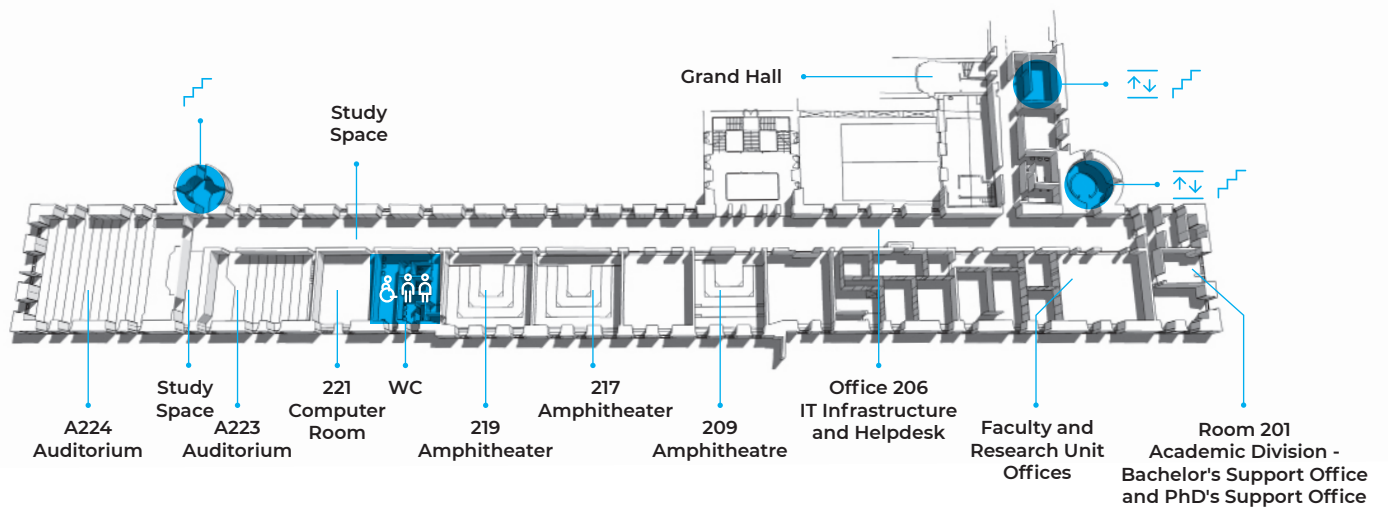

1ST FLOOR

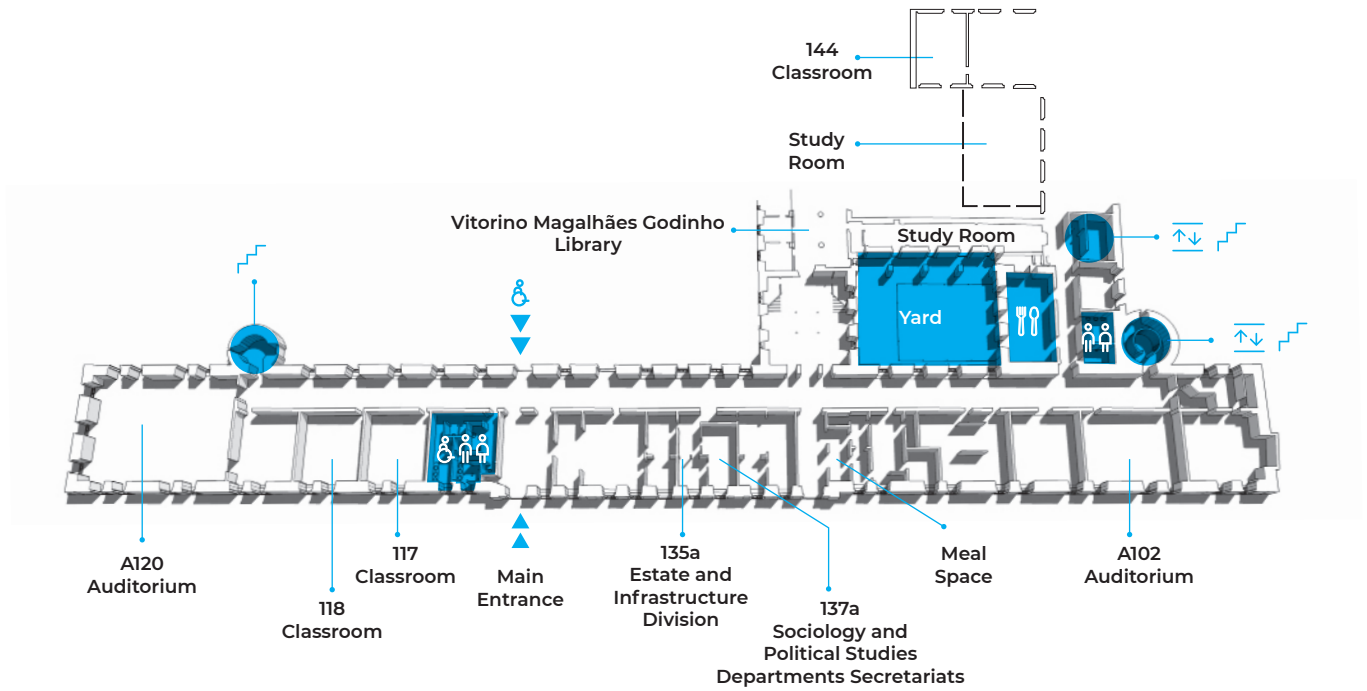

FLOOR 0

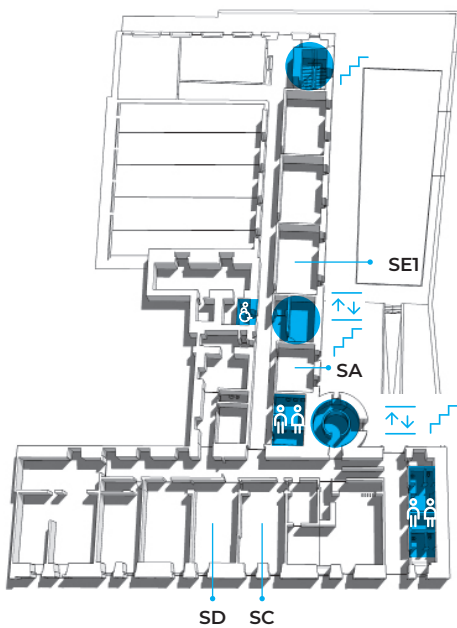

FLOOR -1

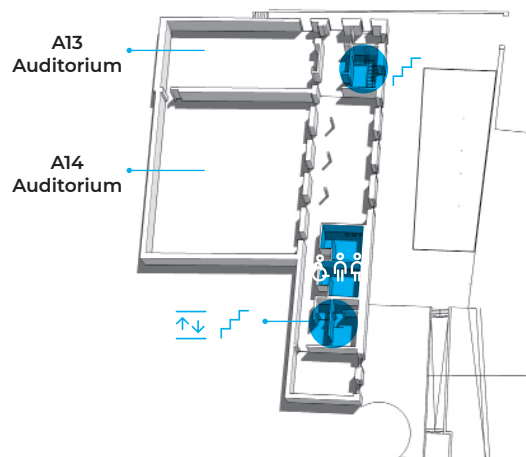

IT SUPPORT

Almost all the computer services provided, being online, work equally in Colégio Almada Negreiros as in Av. de Berna - Inforestudante, email, Intranet, Moodle, Microsoft 365, wireless eduroam and access to scientific databases.



As in Av. Berna, at Colégio Almada Negreiros requests for computer support are addressed to the IT and Digital Transformation Division email: helpdesk@fcsch.unl.pt

In person support should be previously combined with the IT Support.

Contacts:

E-mail: helpdesk@fcsch.unl.pt

General - 217 908 300 ext. 40203

Ricardo Miguel Monteiro - 910 137 124 (8am - 4pm)

Paulo Grácio - 926 005 852 (11am - 7pm)



Working Hours:

Helpdesk

Mon to Fri 9am – 6pm

Support to Classrooms

Mon to Fri 8am – 7pm



Room 206 (2nd floor)



Shared space

INTERNET ACCESS ON CAMPUS

Wireless network

NOVA FCSH's Wi-Fi antenna park covers the campus. Libraries, auditoriums, computer rooms, classrooms, patio-terrace, bars and canteen have wi-fi coverage.

Access is made exclusively through the network eduroam, which is accessed with the FCSH ID credentials.

With these same FCSH credentials you can also access the internet at all Portuguese and European universities, since eduroam is the wireless network of European universities.

[Our page](#) allows you to follow all the steps to eduroam configuration for various operative systems.

NOVA FCSH's IT Services are available to provide technical support and answer questions that may arise.

Cable

In NOVA FCSH's study rooms there are network sockets to connect laptops. For this, you must use a UTP network cable and introduce the following data in the manual configuration of the browser network proxy:

Proxy: proxy.fcsch.unl.pt

Port: 3128

- In Internet Explorer, these fields are in: Tools > Internet Options > Links > LAN settings
- In Firefox, these fields are in: Tools > Options > Advanced > Network > Settings
- On Mac OS, this data is part of the Control panel network.

NOVA FCSH's internal network allows, from the outset, Internet access only via HTTP protocols and HTTPS (web pages).

Accessing external locations through other protocols (such as POP or FTP) is assigned upon request, to be made to the Helpdesk service of the Computer Core.

Email: helpdesk@fcsch.unl.pt

CANTEEN AND BARS

The SASNOVA canteen is located near the Alfredo de Sousa Residence and practices the same prices as Av. de Berna's.

Inside the Colégio building there is a privately explored bar that serves meals at lunchtime.

You can heat up your meals in the microwave located in different areas of the building.

